

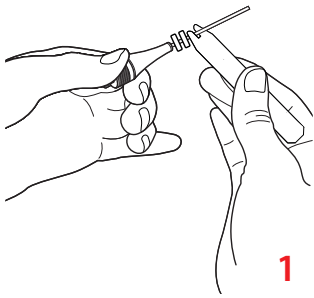

# MAP Kits

The MAP Kits (MAP System) are used in hospital environments, clinics or dental offices by qualified dental personnel. The MAP System is designed for manually placing PD™ MTA White endodontic repair material.



1

Place one or more silicone stops on the tip of the corresponding needle using the key.

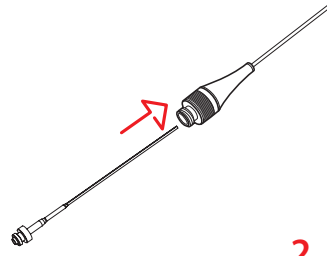

2

Insert a plastic plunger into the corresponding needle.

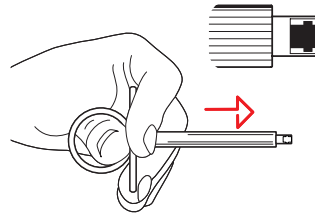

3

Press the piston of the MAP Syringe so that the bayonet tip appears.

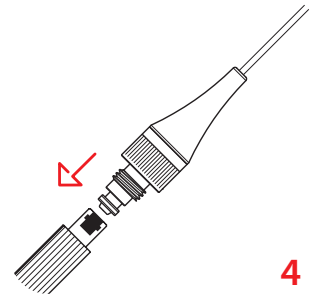

4

Fit the plunger bayonet counter system and release the syringe piston.

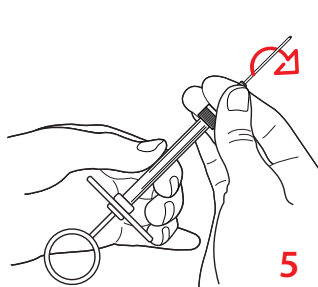

5

Screw the head into the syringe. If a *NiTi Memory Shape needle* is used, adjust the shape of the needle manually to any required curvature.

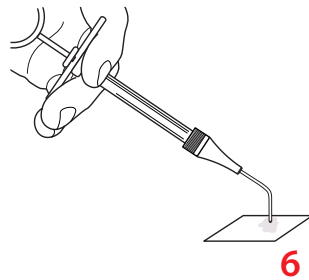

6

Prepare the repair material on a glass tab and transfer the required quantity of material into the filling well. Thrust the tip (of the needle) into the repair material several times so that it is filled.

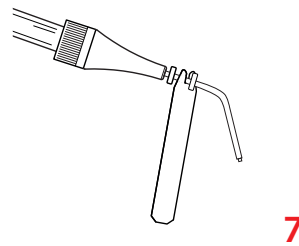

7

Remove excess material by sliding one silicone stop outside the end of the tip.

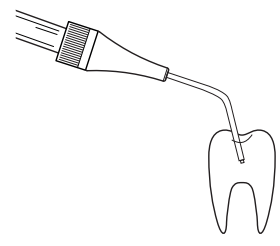

8

Press the syringe piston to expel the material. Fill the instrument again if necessary.

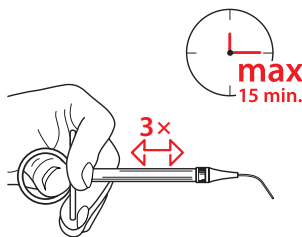

9

When the material has been fully placed, press the syringe piston 3x within 15 minutes after the treatment to expel the excess material.

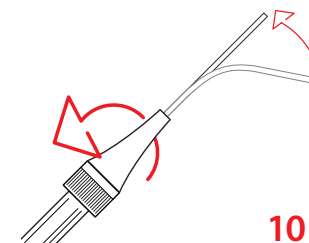

10

If a *NiTi Memory Shape needle* is used, straight up the needle manually. Unscrew the head.

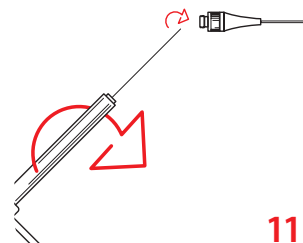

11

Press the syringe piston and take the plunger out of the bayonet system.

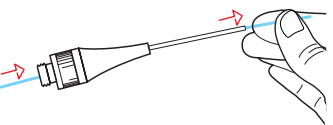

12

Clean the inside of the head a stiff threader dental floss like EMOFORM TrioFloss or ProxySoft 3 in1 Floss. For more detail see step number 1 of the reprocessing protocol.

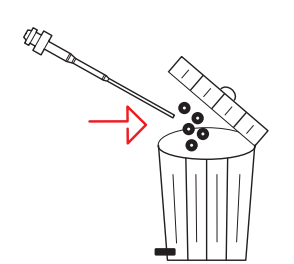

13

Remove and discard any used or remaining silicone stops.

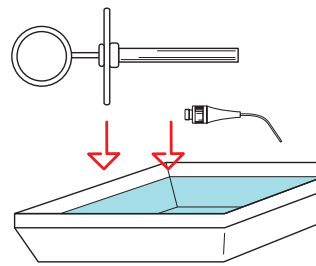

14

Clean all other parts immediately in order to remove any residual material. Note: the plastic plungers must be discarded after 1 use and replaced.

## Warnings Before use:

The single-use plastic plunger must be cleaned and disinfected before use. Sterilization of reused instruments is essential before use.

## After use:

Clean inside the head within 15 min. with a stiff threader dental floss like EMOFORM TrioFloss or ProxySoft 3 in1 Floss. If this is not done, it may be very difficult, if not impossible, to unblock and clean the device.